

# PRODUCT UPDATE

## Fan Clutch Kits

★ **New!**

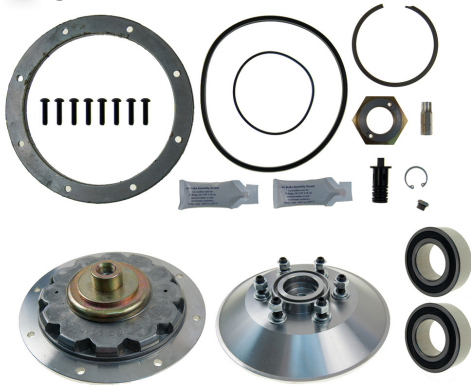

— 295568 —

Kit, Super, DM Advantage Type,  
Complete with 1 X 7209 Bearings

★ **New!**

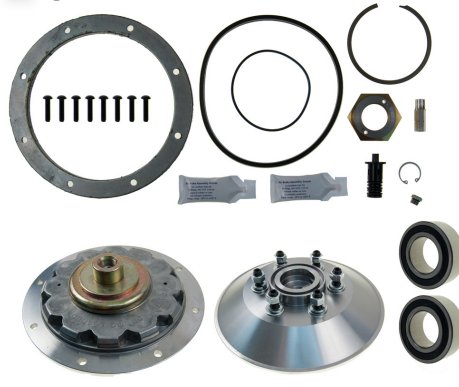

— 295575 —

Kit, Super, DM Advantage Type,  
Complete with 2 x 5209 Bearings

★ **New!**

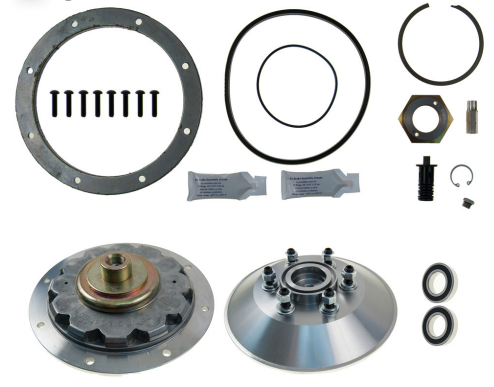

— 299985 —

Kit, Super, DM Advantage Type,  
Complete with 2 x 6209 Bearings

Ride-Air#	Lining Kits
294349	Drivemaster Style Lining Kit
294246	9.5" "HTS" Lining Kit
294212	7.5" "S", Lining Kit



294349

Ride-Air#	Super Kits
294305	9.5" "HTS" Super Kit
294307	7.5" "S" Series Super Kit



294305

Ride-Air#	Seal Kits
294205	Seal Kit "S" And "HTS"
294346	Seal Kit Drivemaster



294346

Ride-Air#	Description	O.E.M. Horton	Kit Master
294205	S & HTS SEAL KIT	994205	4205
294305	9" HTS SERIES SUPER KIT	992305	9500HP
294307	7" S SERIES SUPER KIT	994307	7500HP
294314	7" S SERIES MAJOR KI	994314	7500H
294315	9" HTS SERIES MAJOR KIT	994315	9500H
295568	DRIVEMASTER SUPER KIT (Single Bearing Design)	995568	14-256
295575	DRIVEMASTER SUPER KIT (Dual Bearing Design)	995575	N/A
299985	DRIVEMASTER SUPER KIT (Dual Bearing Design)	995985	N/A